

Fiber Connectors & Accessories

SC UPC/ APC FIELD ASSEMBLY CONNECTORS

Quick Start Guide **V1.0**

1

Product View

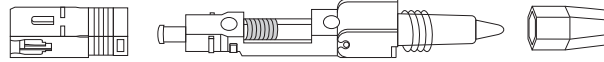

SC housing

Fast connector

Screw cap

2

Accessories

Optional (Not Included)

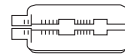

x1



x1



x1



x1

3

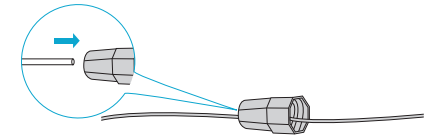

4

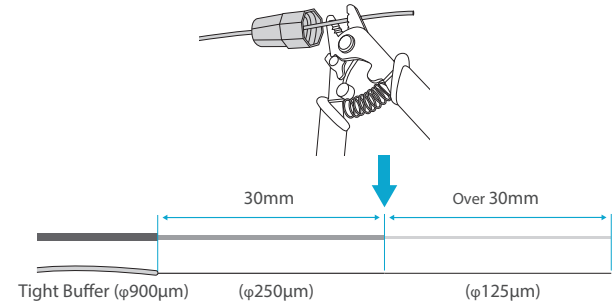

NOTE:

1. Strip off the 900µm tight buffer to 250µm and 125µm as shown above.
2. Clean the fiber after stripping.

5

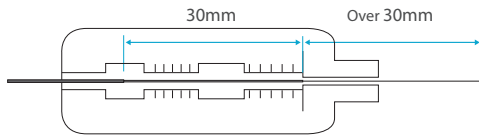

Length Fixed Instrument

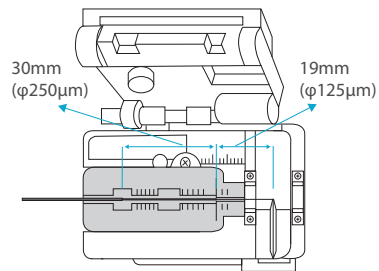

Cleaver

NOTE: Cut the bare fiber of 125µm to be 19mm with a cleaver and check the length.

6

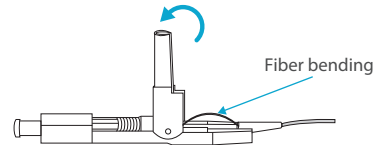

NOTE: Do not break the fiber.

7

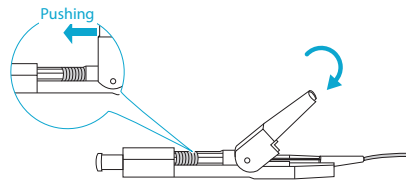

NOTE:

1. Push the yellow cover towards the top to lock the fiber.
2. If you need to reassemble the fiber, pull the yellow cover in reverse with procedure 7. Then pull out the fiber and reassemble.

8

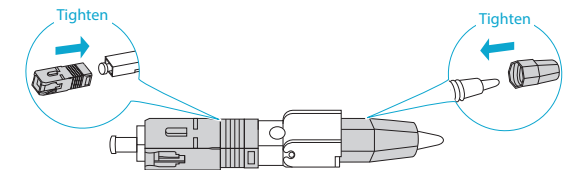

NOTE: Tighten the housing and the screw cap, then the fiber cannot be reassembled.