

NETWORKS

USB2.0 HDMI KVM SWITCH USER MANUAL



Contents

Chapter 1 Introduction	1
Chapter 2 Product Features.....	1
Chapter 3 Product Appearance & Structure	2
Chapter 4 Installation Instructions.....	3
Chapter 5 Instructions of Front Panel Buttons	4
Chapter 6 Hot Key Operations.....	5
Product Warranty Card	
Contact Us	

Chapter 1 Introduction

Thank you for purchasing the FS HDMI KVM Switch.

FS HDMI KVM Switch is a control device to control multiple computers via a set of monitor-keyboard-mouse, which provides both style and multi-functionality for today's multimedia SOHO environment. It provides seamless HDMI signal switching between PCs or other HDMI-enabled devices, such as FPD, Plasma display, digital television and television set-top box.

It's easy and fast to install the HDMI KVM Switch. You just need to connect cables to relevant ports, no software required.



Figure 1-1

Before you begin installing the switch, make sure you have all of the package contents available.

Package Contents

- FS HDMI KVM Switch
- Power adapter
- Signal cable
- Display cable
- Remote control

Chapter 2 Product Features

- One USB console controls four HDMI-interface computers.
- HDMI digital monitor support-fully compliant with HDMI1.3a and HDCP.
- Dolby True HD and DTS-HD Master Audio support.
- Fully compliant with the USB 2.0 specification.
- Independent switching of KVM, USB peripheral, and audio focus.
- Superior video quality support-1080P (1920 x 1200) .
- Support widescreen resolutions.
- Multiplatform support-Windows2000/XP/Vista, Linux, Mac.
- Compatible with wireless USB keyboard and mouse from Logitech and other factories.

- Compatible with wireless USB keyboard and mouse from Logitech and other factories.
- Support multimedia USB keyboard (PC, Mac and Sun).
- USB and PS/2 keyboard/mouse emulation for error-free booting.
- Video DynaSync™-stores the console monitor's EDID (Extended Display Identification Data) to optimize display resolution.
- No software required-easy switching between PCs via front panel pushbuttons, keyboard hotkeys and infrared remote control.
- Auto Scan Mode for monitoring all computers and HDMI devices.
- Hot pluggable-add or remove computers without having to power down the switch.

Chapter 3 Product Appearance & Structure

Front View

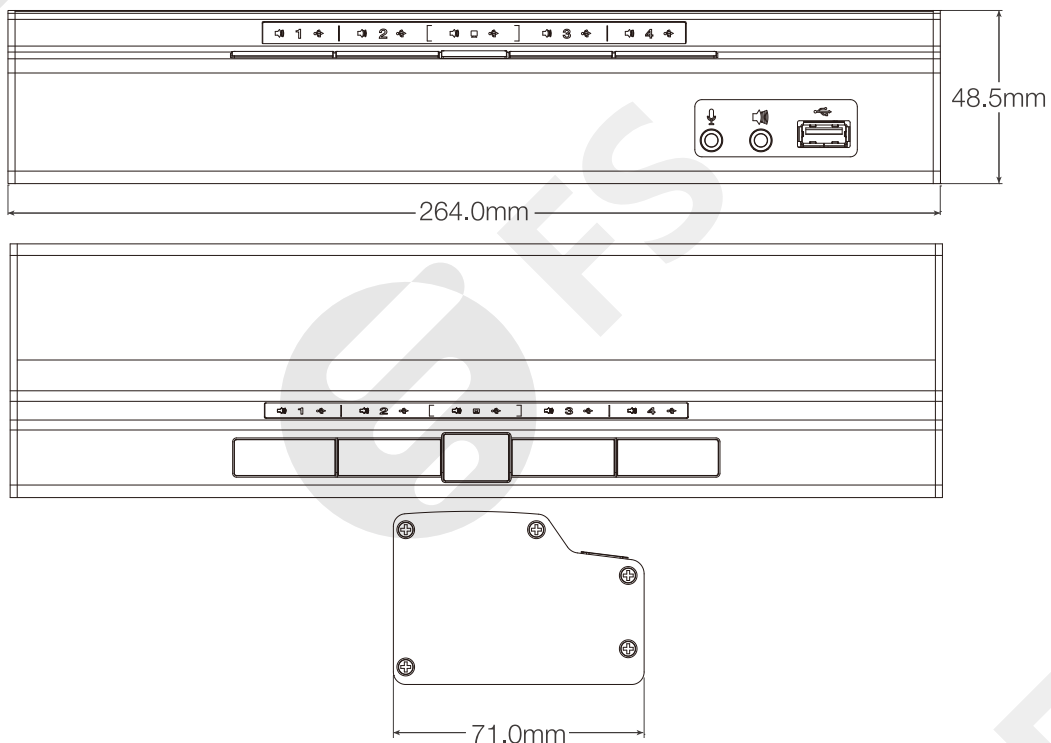

Figure 3-1

Rear View



Figure 3-2

NO.	Instructions
1	Firmware upgrade port
2	Peripheral USB2.0 port
3	Console audio port
4	Power port
5	Console USB port (keyboard, Mouse)
6	Console HDMI port
7	KVM port

Table 3-1

Chapter 4 Installation Instructions

Before installation, make sure all the devices that to be connected are powered off.

1) Connect the monitor, USB keyboard and mouse to the local console port on the device (see ① in below figure).

2) Connect the PC to the KVM Switch with HDMI cable (see ② in below figure).

3) Connect the power adapter to the KVM power port (see ③ in below figure).

Power on the PC to switch via front panel pushbuttons, keyboard hotkeys and infrared remote control.

5) If a separate speaker or microphone is used, connect the speaker or microphone to the audio port on the KVM device (see ④ and ⑤ in above figure).

6) Connect the USB peripherals to the USB port (see ⑥ in above figure).

*If the console monitor has a built-in speaker and supports audio through the HDMI connector, you do not need to use a separate speaker.

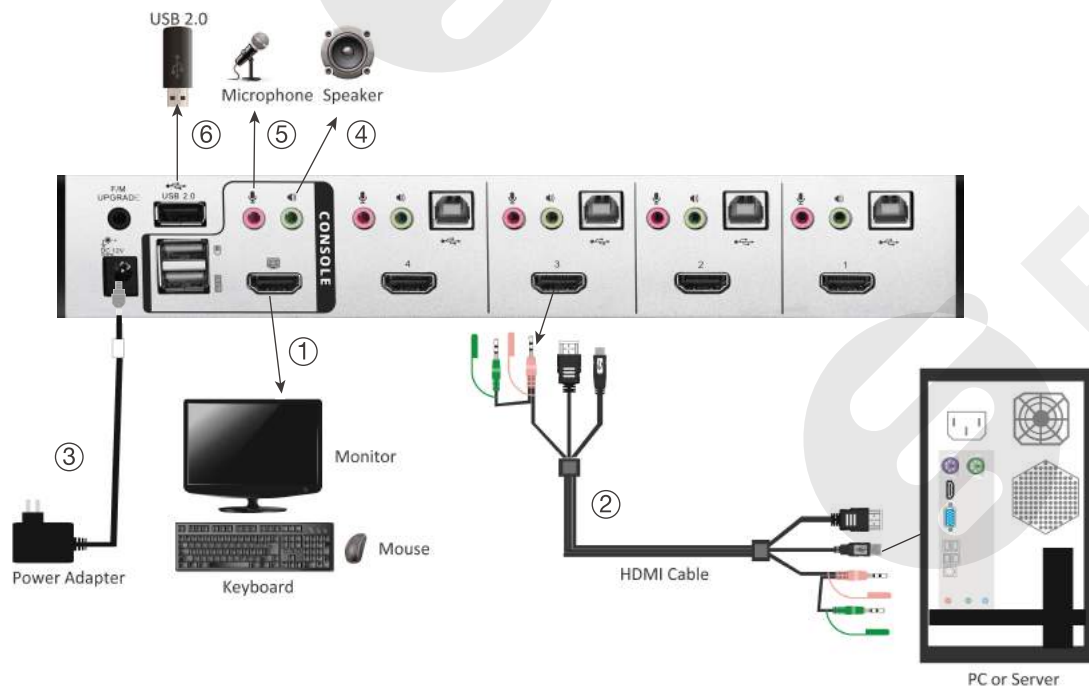

Figure 4-1

Chapter 5 Instructions of Front Panel Buttons



2: LED lights 1: MODE pushbutton

Figure 5-1







NO.	Pushbutton (1)	LEDs (2)	Functions
1	Infrared remote control A-D		After setting the Mode function, press the relevant number button to switch. E.g.: Press A (CH1) and the audio, KVM port and USB LED light is on (as shown in the left column), which shows that the audio, KVM and USB function of port 1 are available.
2	Number button 1-4		After setting the Mode function, press the relevant number button to switch. E.g.: Press button 1 and the audio, KVM port and USB LED light is on (as shown in the left column), which shows that the Audio, KVM and USB function of port 1 are available.
			This allows you to cycle through the three modes of focus-audio, KVM and USB.
	MODE		Press the Mode pushbutton, switching between KVM and USB focus.
			Press the Mode pushbutton twice, switching between KVM and audio focus.
			Press the Mode pushbutton three times, switching KVM function.

Table 5-1

Mode pushbutton cycle switching:

Video, KVM and USB cycle switching mode (default mode) --> Press the Mode pushbutton once, switching between KVM and USB function--> Press the Mode pushbutton twice, switching between KVM and audio function--> Press the Mode pushbutton three times, switching KVM function--> Press the Mode pushbutton four times, back to cycle switching mode.

Chapter 6 Hot Key Operations

Press the “L_ Ctrl” key twice (with 2S interval), the keyboard is under hotkey mode after hearing one beeper sound. The keyboard will exit the hotkey mode if you do not press any hotkey within 2 seconds.

Hotkey command as below: Press “L_ Ctrl” key twice + corresponding key.



Function Name	Operation	Function Description
Port switching	+F1 ~ F4	Switching between port 1-4 (Brings the KVM, USB and audio focus from the current port to the next port).
	+↑ / ↓	Switching to Previous or next port.
Audio switching	+1~4 on small number pad	Brings the audio focus to the computer attached to the specified port.
KVM switching	+1~4	Only brings the KVM focus to the computer attached to the specified port. The USB and audio focus remain where they are.
KVM + Audio switching	A+1~4	Brings the KVM and audio focus to the computer attached to the specified port. The USB focus remains where they are.
KVM+USB switching	U+1~4	Brings the KVM and USB HUB focus to the computer attached to the specified port. The audio focus remains where they are.
Hotkey beeper control	+Z	Toggles the beeper On and Off.
Auto Scan	+S	Invokes Auto Scan. The KVM focus cycles from port to port. Press any key to exit the auto scan mode.
Hotkey cycling	+F	Invoke the hotkey cycling mode (Scroll  Shift  Ctrl)
Broadcast function	+B	Under broadcast mode, the computer keyboard and mouse can be operated synchronously.

Table 6-1

Product Warranty Card

FS ensures our customers that any damage or faulty items due to our workmanship, we will offer a free return within 30-Days from when you receive your goods. This excludes any custom made items or tailored solutions.

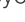
What this warranty covers?

This warranty is only available for the original buyer and is not transferable to a third-party.

- Within the first 30 Days of purchase, if for any reason you are not satisfied with your purchase (except custom made items or tailored solutions), simply return it for a refund or replacement.
- Within the first 3 Year of purchase, free repair or maintenance due to manufacturer's defects (including shipping, handling and parts costs).
- More than 3 years of purchase, repairs and maintenance will be charged as appropriate.

What is NOT covered?

This warranty is non-transferable and does not cover if the product:

- Has been modified and/or altered, or an addition made thereto, except by FS authorized representatives, or as approved by FS in writing.
- Has been painted or physically modified in any way.
- Has been subjected to misuse, abuse, negligence, abnormal or physical stress, including accident.
- Has been damaged or impaired as a result of using third party firmware.
- Has no original FS label, or miss any other original labels.

FS sole and exclusive obligation and liability under the foregoing warranty shall be for FS, at its discretion, to repair or replace any product that fails to conform to the above warranty during the warranty period. The expense of removal and reinstallation of any product is not included in this warranty. The warranty period of any repaired or replaced products shall not extend beyond its original warranty expiry.

Return Conditions

If you return for refund or replacement within **30 Days**, please make sure that the product must be in new or like-new condition with its original trademark and **SN number (the SN number is the unique identification number of every product)**, manual and accessories that were included when delivered to you. Return for replacement or repair is due to an error on our part (you received an incorrect or defective item, etc.), we will cover the shipping and repair cost and customs duty (for international purchase). Otherwise, you are responsible for these charges of returning or repairing items on your own.

FS offers two channels to process your return request, if you purchase from FS website, you may visit the website and log in to your FS “account “center to start a quick return. If you purchased by emails, you may contact your sales representative or visit our website fs.com to talk with customer service team and obtain an approved Return Materials Authorization (RMA) Number. Products returned without a RMA Number will not be processed and will be returned freight collect or subject to disposal. Information on how to start return can be found at https://www.fs.com/day_return_policy.html

Addresses, phone number and fax number also have been listed at www.fs.com. Please e-mail us at sales@fs.com or call us for assistance. All statements, technical information, and recommendations related to the products here are based upon information believed to be reliable or accurate. However, the accuracy or completeness thereof is not guaranteed, and no responsibility is assumed for any inaccuracies. Please contact FS for more information.



Eastern America

FS.COM INC 380 Centerpoint Blvd
New Castle, DE 19720
United States

Europe (Germany)

FS.COM GmbH
NOVA Gewerbepark Building 7,
Am Gfild 7, 85375 Neufahrn bei Munich, Germany
Tel: +49 (0) 89 414176412

Europe (United Kingdom)

Fiberstore LTD 2nd Floor, Quayside Tower,
Broad Street, Birmingham, B1 2HF
Tel: +44 (0) 121 698 2099

Asia (China)

Fiberstore Co., Limited Room
2702, 27 Floor Yisibo Software Building
Haitian Second Road, Yuehai Street
Nanshan District Shenzhen, 518054, China
Tel: +86 (755) 8300 3611

Australia

FS.COM PTY LTD
57-59 Edison Rd, Dandenong South,
VIC3175, Australia
ABN 71 620 545 502
Tel: +61 (2) 8317 1119

For more information
Visit Us at www.fs.com