



# FS Enterprise Wi-Fi Access Point

## Quick Start Guide V1.0

### Introduction

Thank you for purchasing the FS Enterprise Wi-Fi Access Point. This Quick Start Guide is designed to guide you through installation.

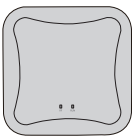

FS-AP733C

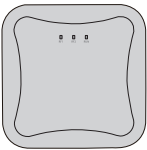

FS-AP1167C



FS-AP3000C

### Accessories

FS-AP733C/FS-AP1167C

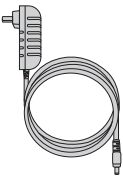

Power Cord x1

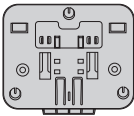

Mounting Bracket x1



Anti-theft Key x1



Screw x2



Screw Anchor x2

FS-AP3000C

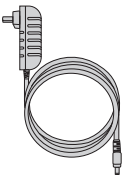

Power Cord x1

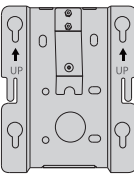

Mounting Bracket x1

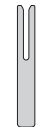

Anti-theft Key x1



Screw x4



Screw Anchor x4

### Optional Installation Tools

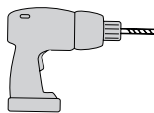

Portable Hammer Drill x1



Rubber Hammer x1



Screwdriver x1



Marker x1

### Hardware Overview

#### LEDs

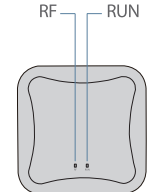

FS-AP733C

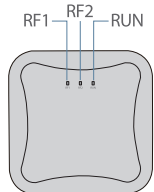

FS-AP1167C

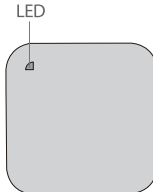

FS-AP3000C

FS-AP733C/FS-AP1167C

LEDs	LED Color	Description
RF	Steady Blue	Enable 5.8G wireless, no data is transmitted
	Flashing Blue	5.8G wireless data transmission
	Steady Green	Enable 2.4G wireless, no data is transmitted
	Flashing Green	2.4G wireless data transmission
RF1	Slowly Flashing	Enable 5.8G wireless
	Quickly Flashing	5.8G wireless data transmission
RF2	Slowly Flashing	Enable 2.4G wireless
	Quickly Flashing	2.4G wireless data transmission
RUN	Bright	Power on
	Off	Power off

FS-AP3000C

LED Color	Description
Off	Power off or the LED is turned off
Four-Color Cycle	Bootloader is running
Steady Blue	The system is initializing
Flashing Blue	Initialization is complete and a CAPWAP link is being established
Steady Green	AP is online, no terminal is associated
Flashing Green	AP is online, the terminal is associated
Steady Red	Error
Flashing Yellow	Firmware update, do not restart or power down
Steady Yellow	Uplink is down

### Ports

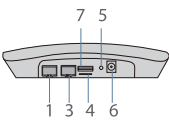

FS-AP733C

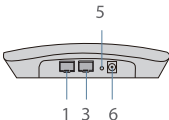

FS-AP1167C

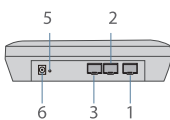

FS-AP3000C

Number	Ports	Description
1	WAN/POE, GE0/POE	WAN/PoE port
2	GE1/POE	LAN/PoE port
3	LAN, GE2	LAN port
4	TF	TF card interface
5	Reset	Restore to factory default settings
6	Power	Used to connect the power
7	USB	USB 2.0 compliant

### Safety Recommendations

To avoid possible bodily injury and equipment damage, read the following safety recommendations before installing the AP. Note that the recommendations do not cover every possible hazardous condition.

- Make sure the floor of the installation site is dry and flat.
- Keep the AP clean and dust-free.
- Place the AP in a dry area and avoid liquid intrusion.
- Keep the AP and installation tools away from walkways.

### Hardware Installation

#### Ceiling Mount

1. Position the mounting bracket at the desired location on the ceiling. Use a marker to mark the two mounting holes.

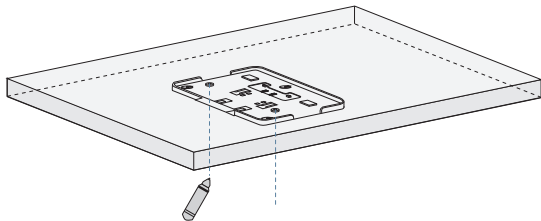

- Drill holes with a diameter of 6 mm (0.24 in) in the marked locations.
- Insert a screw anchor into each hole, and tap the screw anchor with a rubber hammer.

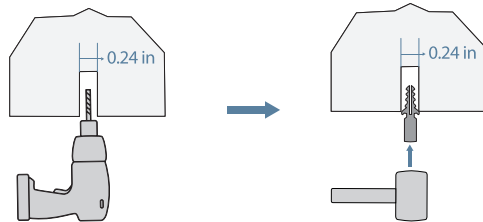

#### NOTE:

The diameter of the holes is different due to the material of the wall.

- Use the screw anchor  
Drywall: 11-12 mm  
Cement wall: 6 mm
- Without the screw anchor  
Aluminum gusset and wood: 3 mm

4. Secure the mounting bracket to the ceiling by inserting the screws into the anchors.

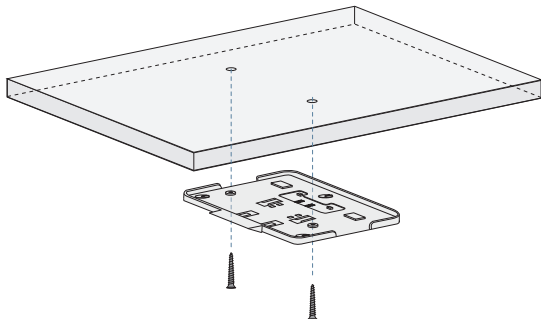

5. Align the tabs on the AP bracket into the notches on the ceiling bracket, and then slide the AP until it snaps into place.

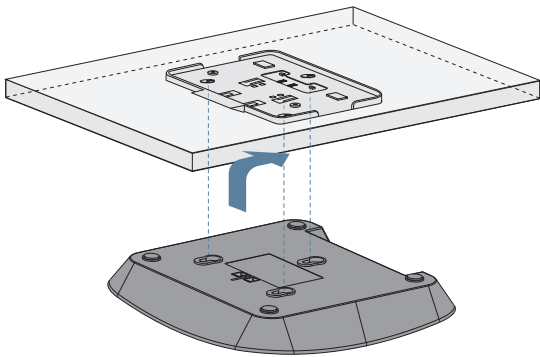

**NOTE:** The wall mount installation is the same as the ceiling mount.

Anti-theft and Disassembly

FS-AP733C/FS-AP1167C

- 1. Anti-theft  
During installation, the locking tab fits securely into the locking notch on the AP to help prevent theft.
- 2. Disassembly  
Insert the anti-theft key and push it to release the locking tab from the locking notch.

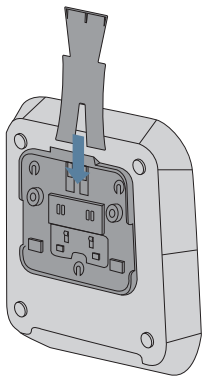

FS-AP3000C

- 1. Anti-theft
  - Install the anti-theft: Loosen the screw so that the spring clip is slightly higher than the mounting bracket on which the UP arrow is engraved (see Fig. 1).
  - Remove the anti-theft: Tighten the screw so that the tail of the spring clip contacts the mounting bracket (see Fig. 2).

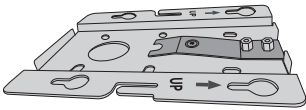

Fig. 1

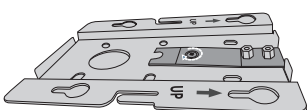
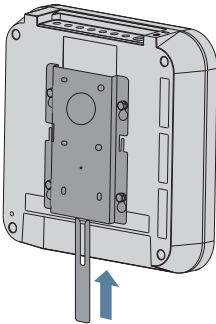

Fig. 2

- 2. Disassembly  
Insert the anti-theft key and push it to release the locking tab from the locking notch.



Powering the FS AP

- The AP supports PoE power supply and local power supply.  
Check the following items before powering on the AP:
- To power the AP with the local power, make sure the local power supply is reliably grounded.
  - To power the AP through PoE, make sure the PoE power supply (PSE) is reliably grounded.

Connecting to the PoE Power Supply

Use an Ethernet cable to connect the Ethernet port on the AP to a port on a switch that supports PoE.

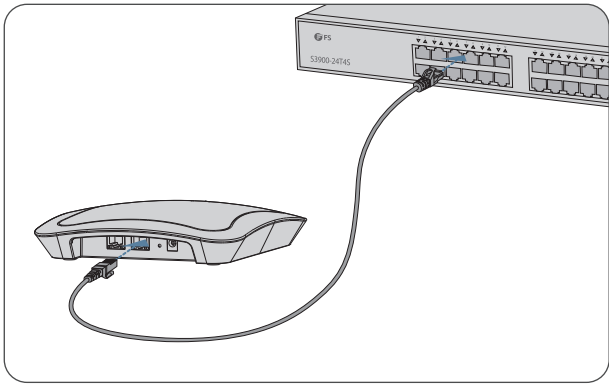

Connecting to the Local Power Supply

Use the power adapter to connect the power port of the AP to the local power source.

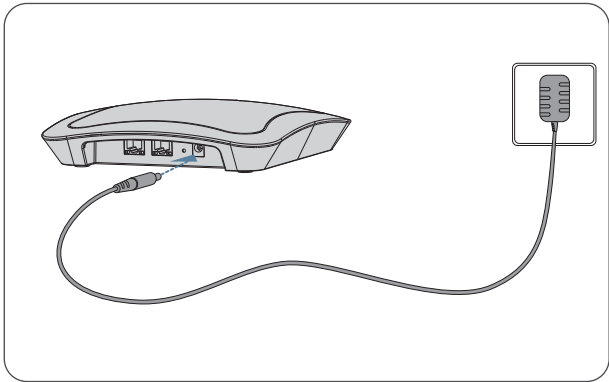

Configuring the Wireless Access Point

Configuring the AP Using the Web-based Interface

- Step 1: Connect your computer to any Ethernet port of the AP using the network cable.
- Step 2: Set up the IP configuration on your computer. The IP address of your computer should be set in the same subnet addresses of the AP. The IP address is 192.168.1.x ("x" is any number from 2 to 254). The subnet mask should be set to 255.255.255.0.
- Step 3: Open a web browser window. Enter the default IP address of the AP http://192.168.1.1 in the address bar and press Enter.
- Step 4: When the login page appears choose the language that you prefer and enter the username and password.  
The default username is admin and the default password is admin.
- Step 5: Click Login to display the web-based configuration page.

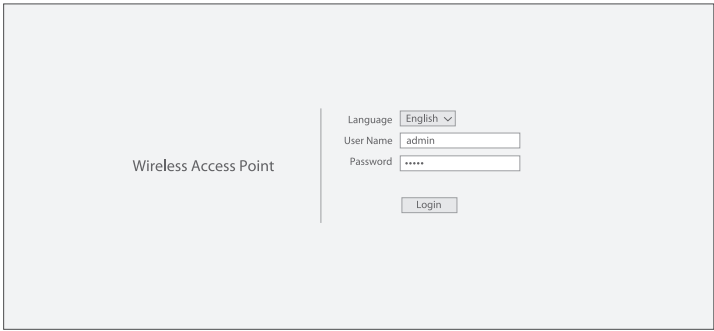

The Screen Displays Request Timed Out

- a) Check if the network cable is intact.
- b) Check if the hardware connection is correct.
- c) The system status indicator on the device panel and the NIC indicator on the computer must be lit.
- d) The computer's IP address setting is correct.

Switching the FAT/FIT Working Mode

- Method one:
- After successful login, enter the command "config terminal", enter the command "service fit-ap disable" to switch the AP to FAT AP mode, enter y after the prompt pops up and press Enter.
  - After successful login, enter the command "config terminal", enter the command "service fit-ap enable" to switch the AP to FIT AP mode, enter y after the prompt pops up and press Enter.

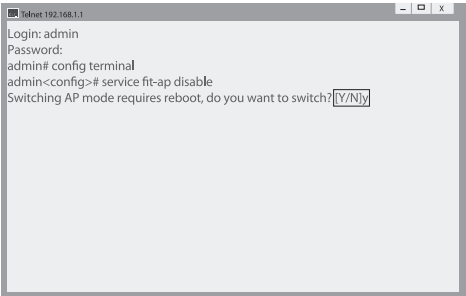

- Method two:
- After login, display with "#", follow the steps below to switch FAT AP and FIT AP mode:

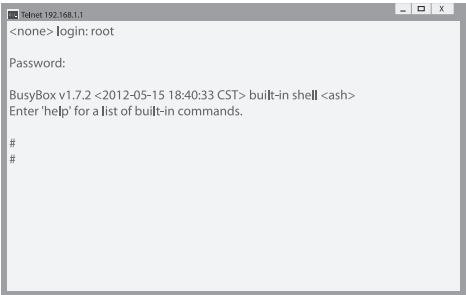

- When ap\_mode has no parameters, it can display the working mode of the current AP. The command is "ap\_mode".
- When it's a FIT AP, displayed as "ap\_mode: fit".
- When it's a FAT AP, displayed as "ap\_mode: fat".
- Switch the AP to FIT AP mode, the command is "Ap\_mode fit".
  - Switch the AP to FAT AP mode, the command is "Ap\_mode fat".

**NOTE:** FS access points work in FIT AP mode by default.

Online Resources

- Download <https://www.fs.com/download.html>
- Help Center [https://www.fs.com/service/help\\_center.html](https://www.fs.com/service/help_center.html)
- Contact Us [https://www.fs.com/contact\\_us.html](https://www.fs.com/contact_us.html)

Product Warranty

FS ensures our customers that any damage or faulty items due to our workmanship, we will offer a free return within 30 Days from the day you receive your goods. This excludes any custom made items or tailored solutions.

- Warranty: All Wireless Access Points enjoy 3 years limited warranty against defect in materials or workmanship. For more details about warranty, please check at <https://www.fs.com/policies/warranty.html>
- Return: If you want to return item(s), information on how to return can be found at [https://www.fs.com/policies/day\\_return\\_policy.html](https://www.fs.com/policies/day_return_policy.html)