

FS-CES12V
12V LITHIUM-ION 3/8" CORDLESS
ELECTRIC SCREWDRIVER
Quick Start Guide **V1.0**

Introduction

Thank you for choosing FS Cordless Electric Screwdriver. This guide is designed to familiarize you with the structure of the electric screwdriver and describes how to use the electric screwdriver in your daily work.

Cordless electric screwdriver may be used for tightening/loosening screws. The ergonomic grip, LED precision light and lightweight allows you to work in the dark, tight areas and awkward positions with ease.

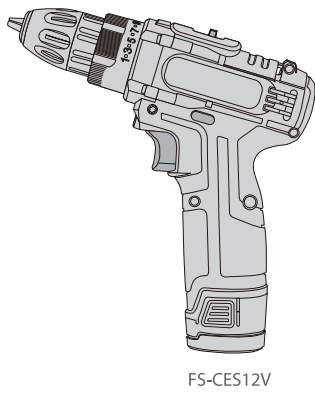

Accessories



Flexible Bit Extension x1



Magnetic Extension Bit Holder x1



Hex Socket x8



Screwdriver Bit x10



Lithium-ion Battery x1



Battery Charger x1

Optional (Not Included)



Socket Wrench x1



Socket Connecting Rod x1

Hardware Overview

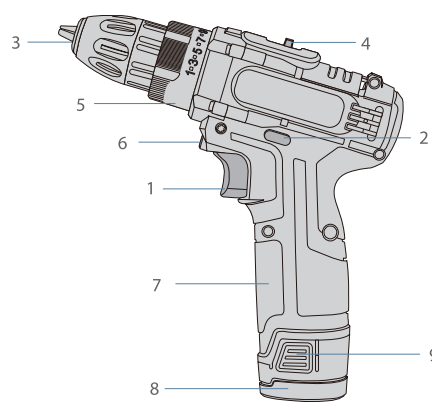

NO.	Part	Description
1	Power Trigger	Turned on and off by pressing and releasing the trigger
2	Forward/Reverse Switch and Safety Lock	Determine the direction of the tool and also serves as a lock off button
3	3/8" Keyless Chuck	Keyless chuck with one rotating sleeve for one-handed operation of the chuck
4	Gear Selector	Two separate gear ranges, low gear and high gear

5	Torque Adjustment Collar	25 settings, the higher the value, the greater the tightening moment
6	LED Precision Light	Turn on automatically when the trigger switch is activated
7	Ergonomic Handle	Hold the tool firmly
8	Rechargeable Battery	A 12v lithium-ion rechargeable battery
9	Battery Release Button	Press the release button and pull the battery out

Installation Safety Precautions

- 1. Work Area Safety:** Keep work area clean and well lit. Do not operate power tools in explosive atmospheres. Keep children and bystanders away while operating a power tool.
- 2. Electrical Safety:** Power tool plugs must match the outlet. Never modify the plug in any way. Do not expose power tools to rain or wet conditions. Do not abuse the cord. Never use the cord for carrying, pulling or unplugging the power tool. Keep cord away from heat, oil, sharp edges or moving parts.
- 3. Personal Safety:** Stay alert, watch what you are doing and use common sense when operating a power tool. Use personal protective equipment. Always wear eye protection. Protective equipment such as dust mask, non-skid safety shoes, hard hat, or hearing protection used for appropriate conditions will reduce personal injuries. Dress properly. Do not wear loose clothing or jewellery. Keep your hair, clothing and gloves away from moving parts.
- 4. Prevent Unintentional Starting:** Ensure that the switch is in the off position before connecting to power source and/or battery pack, picking up or carrying the tool. Keep proper footing and balance at all times. Some material contains chemicals which may be toxic. Take caution to prevent dust inhalation and skin contact.
- 5. Power Tool Use and Care:** Do not force the power tool. Use the correct power tool for your application. Do not use the power tool if the switch does not turn it on and off. Disconnect the plug from the power source and/or the battery pack before making any adjustments, changing accessories, or storing power tools.



WARNING: Read all safety warnings and all instructions. Failure to follow all the warnings and instructions may result in electric shock, fire and/or serious injury.

Installing

Installing and Removing the Battery Pack

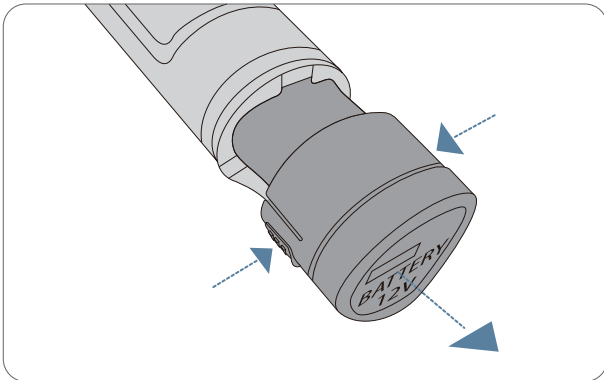

1. To install the battery pack into the tool handle, align the battery pack front shape with the battery installation opening and slip it into place with a little click, and ensure that it does not disengage. If the battery does not slide in easily, it is not being inserted correctly.
2. To remove the battery pack from the tool, press the release button and firmly pull the battery pack out of the tool handle.

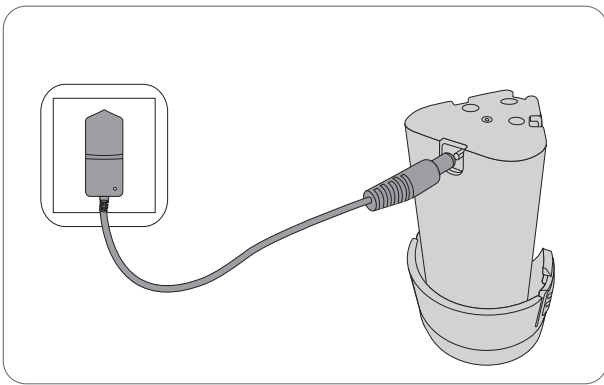

NOTE: Safety Warnings and Instructions for Battery (Before using the charger, read follow instructions.

1. Use power tools only with specifically designated battery packs.
2. Ensure the switch is in the off position before inserting battery pack.
3. Always stop tool operation and charge the battery pack when you notice less tool power. Never recharge a fully charged battery pack.
4. Do not crush, drop or damage battery.
5. Do not allow metallic or conductive objects to both contact battery terminals. And avoid storing battery pack in a container with other metal objects such as nails, coins, etc.
6. Charge the battery pack with room temperature at 10°C-40°C (50°F-104°F).
7. Under abusive conditions, liquid may be ejected from the battery; avoid contact. If battery liquid gets into the eye, rinse water over the open eye for 15 minutes or until irritation ceases, and seek medical attention right away.
8. Do not incinerate the battery pack even if it is severely damaged or is completely worn out. The battery pack can explode in a fire.



CAUTION: To reduce the risk of serious personal injury, turn tool off and remove the battery pack before making any adjustments or removing/installing attachments or accessories.

Variable Speed Trigger

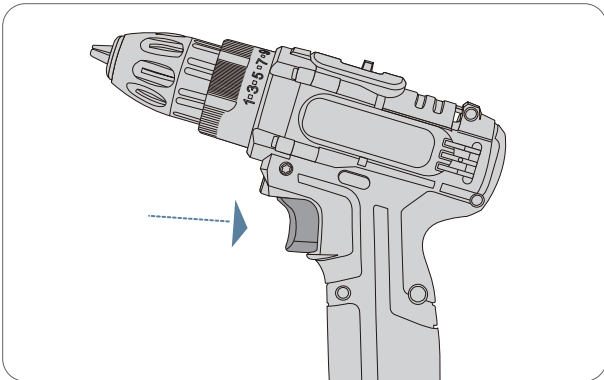

The tool can be turned "ON" or "OFF" by squeezing or releasing the trigger. The speed can be increased by applying more pressure to the trigger.



CAUTION: Before inserting the battery pack into the tool, always check to see that the switch trigger activates properly and returns to the "OFF" position when released. This tool is equipped with an electric brake. The chuck will stop as soon as the trigger switch is fully released.

Torque Adjustment Collar

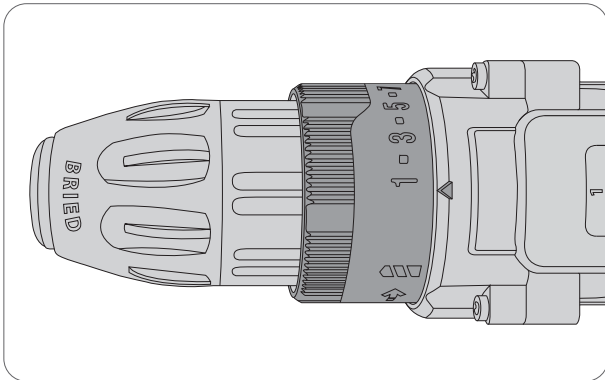

The higher the number on the collar, the higher the torque and the larger the fastener which can be driven.



NOTE: Before actual operation, drive a trial screw into your equipment to determine which torque level is required for a particular application.

Gear Shifting

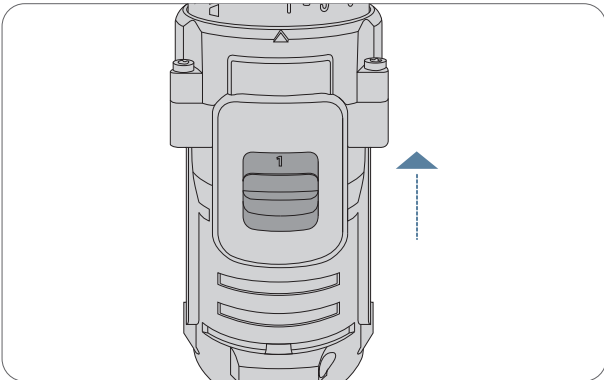

To change the speed, turn the tool off and slide the gear selector to the "2" side for high speed or "1" side for low speed.



NOTE: Be sure that the gear selector is set to the correct position before operation. Use the right speed for your job.



CAUTION: Do not change gears when the tool is running, or the tool may be damaged. Always set the gear selector fully to the correct position. If you operate the tool with the gear selector positioned halfway between the "1" side and "2" side, the tool may be damaged.

Forward/Reversing Switch and Trigger Lock

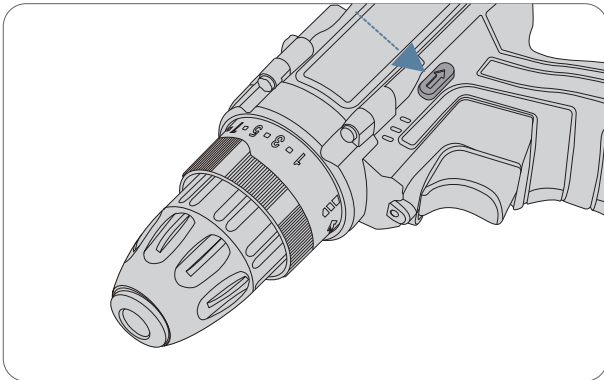

This tool is equipped with a forward/reversing switch and trigger lock. For forward rotation, depress the switch on the right side of the tool; for reverse rotation, depress the switch on the left side of the tool.



CAUTION:

1. Check the direction of rotation before operation.
2. Do not change direction of rotation until the tool comes to a complete stop. Shifting during rotation of the chuck can cause damage to the tool.
3. When not operating the tool, always set the reversing switch to the neutral position.

Turning on the front LED Light

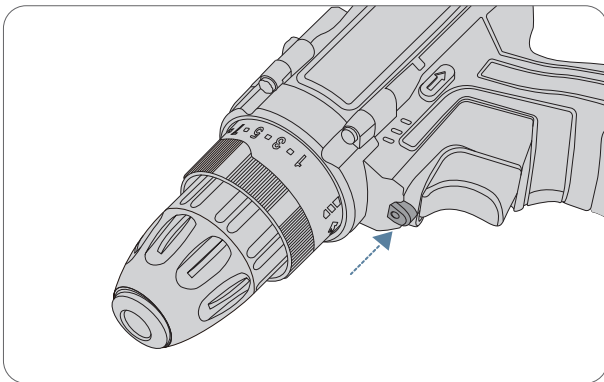

The light is activated when the trigger switch is depressed. If the trigger switch remains depressed, the light will remain on.



NOTE: Use a dry cloth to wipe the dirt off the lens of light. Be careful not to scratch the lens of lamp, or it may lower the illumination.



CAUTION: Do not look in the light or see the source of the light directly.

Inserting Bits

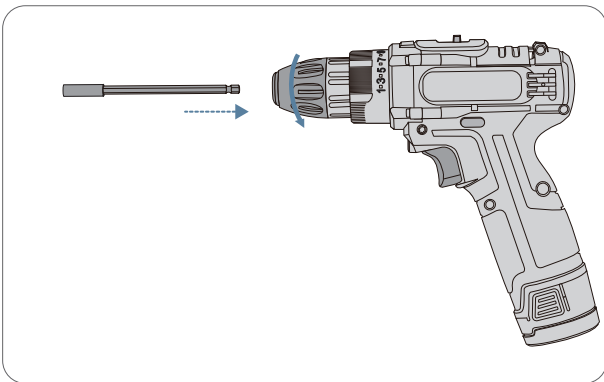

Rotate the chuck sleeve counter-clockwise viewing from chuck end, and open chuck to approximate drill bit diameter. Insert a clean bit in the chuck as far as it will 90°. Close chuck by rotating the chuck sleeve clockwise and securely tighten by hand. To remove the bit, rotate the chuck counter-clockwise.



CAUTION:

1. Always ensure that the tool is switched off and the battery pack is removed before carrying out any work on the tool.
2. Always ensure that the bit is secure before starting the tool. A loose bit may eject from tool causing possible personal injury.

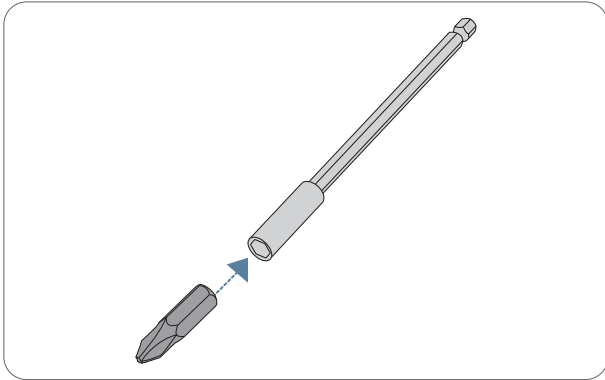

1. Magnetic extension bit holder is great for working with hard-to-reach screws, and strong magnet holds screwdriver bits securely

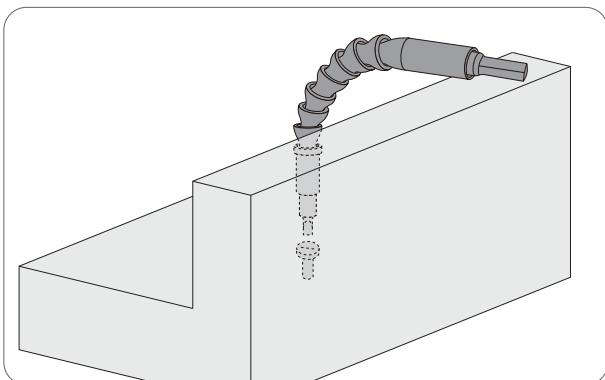

2. Flexible bit extension is of great flexibility to bend, twist and straighten even in narrow confined space.

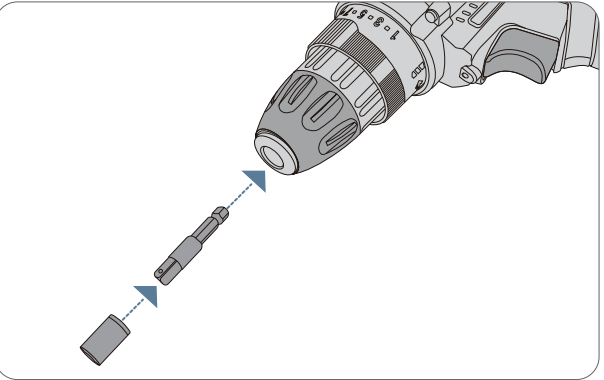
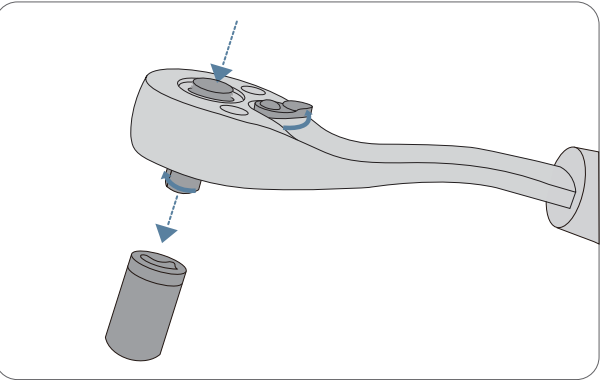

3. Hex sockets installed to socket connecting rods or socket wrenches are used to loosen or tighten the hex head screws and nuts.

Screwdriving Operation

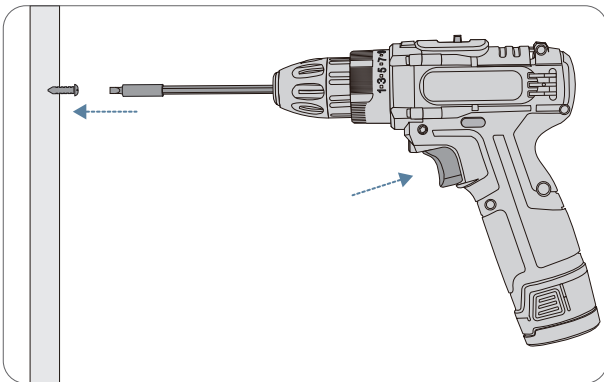

1. Hold the tool firmly with one hand on the grip and the other hand on the bottom of the battery pack to control the twisting action.
2. Place the point of the screwdriver bit align to the screw head and apply pressure to the tool, start the tool slowly and then increase the speed gradually. Release the switch trigger as soon as the screw cuts in.



CAUTION:

1. Turn the torque adjustment collar to the desired position.
2. Make sure that the screwdriver bit is inserted straight in the screw head, or the screw and/or bit may be damaged.

Online Resources

- Download <https://www.fs.com/download.html>
- Help Center https://www.fs.com/service/help_center.html
- Contact Us https://www.fs.com/contact_us.html