

FS-WLA-LC4-8C-E/FS-WLA-SC8-8C

FIBER TERMINATION BOX

Quick Start Guide **V2.0**

1

Product View

- Pigtail wiring
- Fiber wiring
- Installed cable

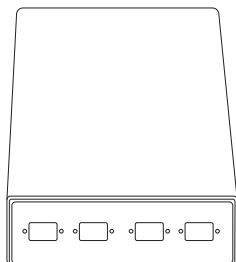

FS-WLA-LC4-8C-E

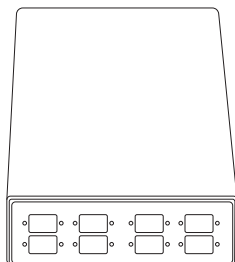

FS-WLA-SC8-8C

2

Accessories



8X (29669)
16X (18000)

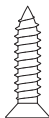

4X

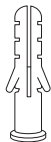

4X



8X



4X

3

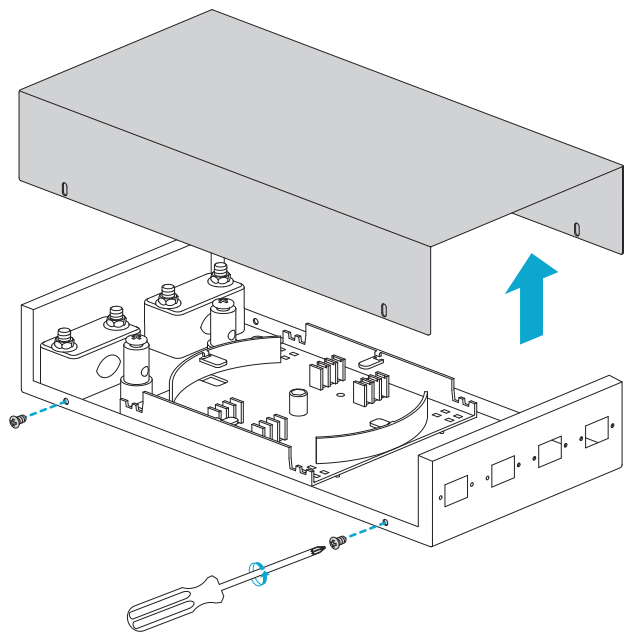

4

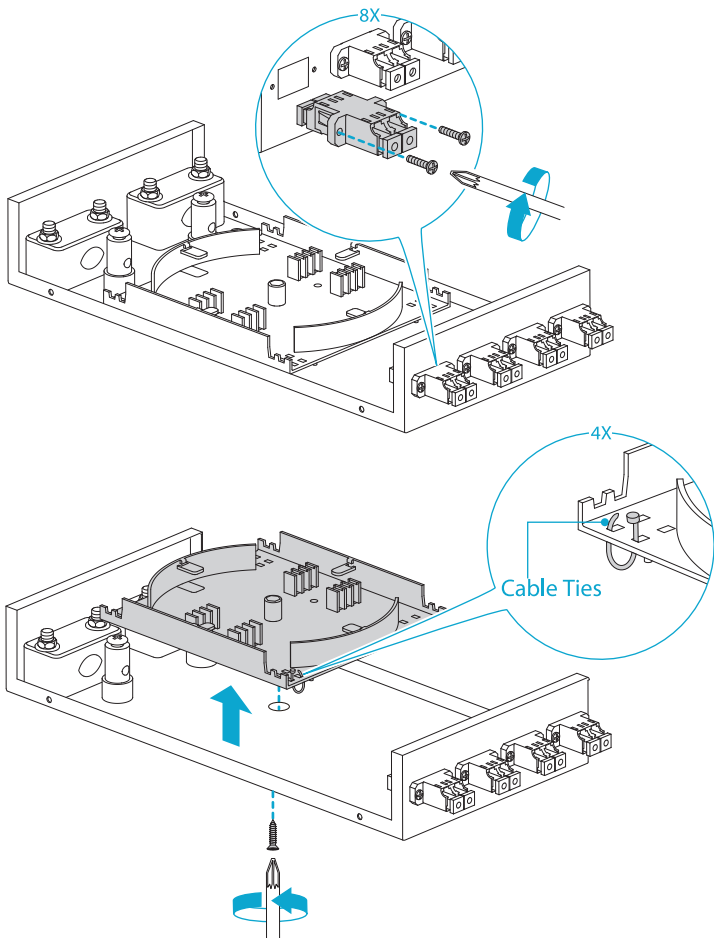

5

Step1: Stripping fiber cable.

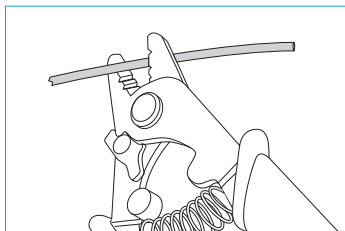

Step2: Remove the screw, fix the cable in the slot, mounting screws and then tighten the cable tie.

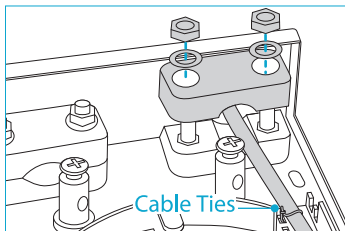

Step3: Tighten the screws to lock Mylar.

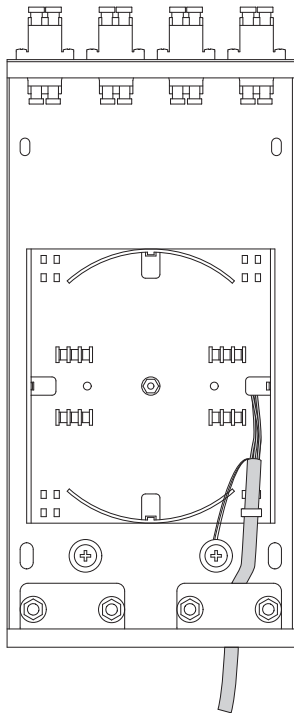
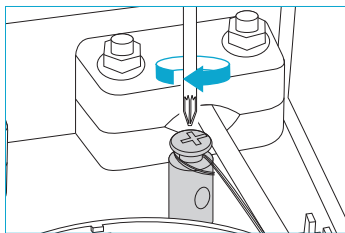

NOTE: The plastic splice tray can be removed by removing the screws on the back.

6

Step1: Connect pigtail to adapter.

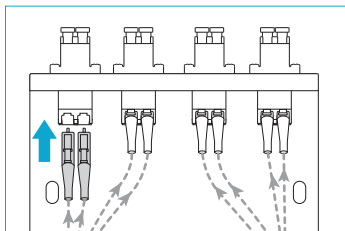

Step2: Spliced fiber in heat shrinkable tube.

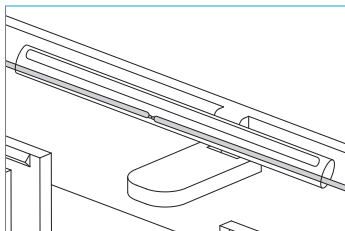

Step3: Fix the heat shrinkable tube to the slot.

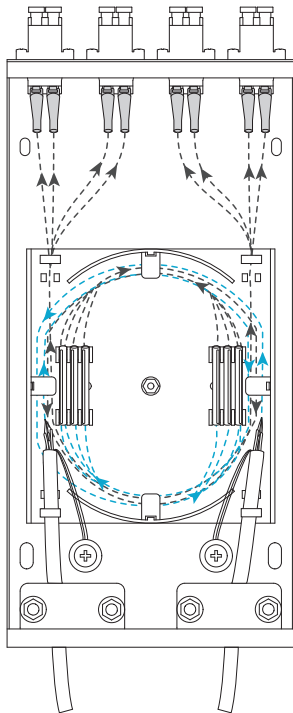
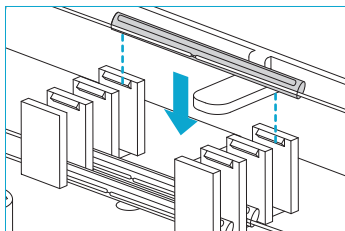

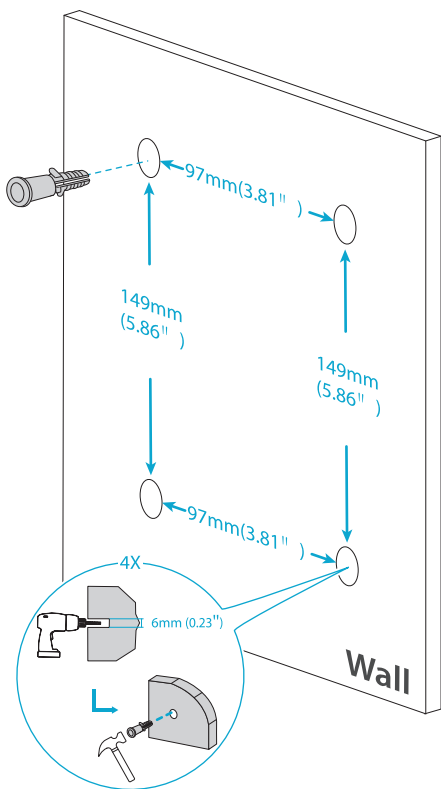

NOTE: Adjust the mounting holes to desired distance.

