

Metered/Monitored/Switched PDU

0U PDU POWER STRIPS

Quick Start Guide **V1.0**

Introduction

Power Distribution Units (PDUs) provide reliable power distribution from a UPS system, generator, or utility source to electronic equipment, servers, and network/telecom devices.

PDU-2PE24I-VMIE



PDU-L6324I-VSW



PDU-3PNE24I-VSW



PDU-L6342I-VMO/PDU-2PE42I-VMIO



Accessories

Metered PDU



M6 Screw x4

Monitored PDU



M6 Screw x4

Switched PDU



M6 Screw x4

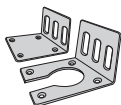

Mounting Bracket x1

Hardware Overview

Metered PDU

Front Panel Buttons

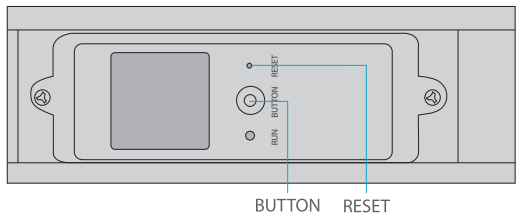

Buttons	Description
BUTTON	Change the display information.
RESET	Restart the device.

Front Panel LED

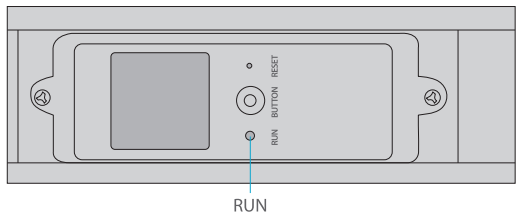

LED	Function	Description
RUN	RUN indicator	Flashing every second.

Monitored PDU

Front Panel Ports

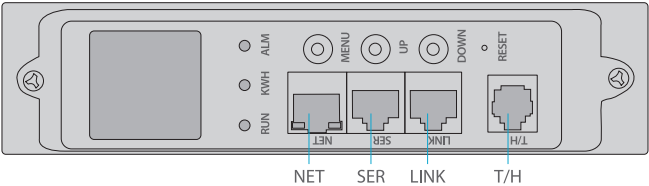

Ports	Description
NET	LAN/WAN Ethernet communication port
SER	RS-485 daisy-chain communication port
LINK	RS-485 daisy-chain communication port
T/H	Temperature/Humidity sensor port

Front Panel Buttons

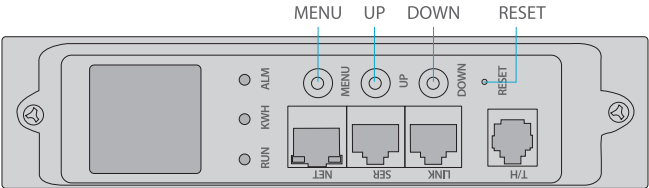

Buttons	Description
MENU	Press to view the PDU status and save the configuration as ENTER key. Restore to factory settings: Press the MENU, then press the RESET. Mute alarming: Press the MENU for 4 seconds to turn on/off the alarm.
UP	Light up the screen, set the address cord and the threshold.
DOWN	Light up the screen, select the address cord and the threshold.
RESET	Restart the device.

Front Panel LEDs

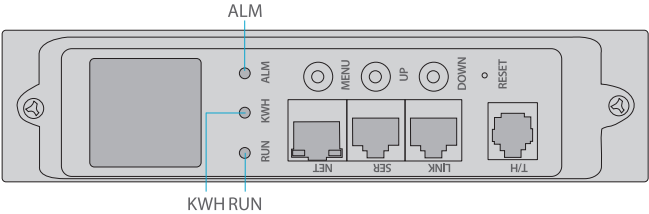

LEDs	Function	Description
RUN	Run indicator	Flashing every second.
KWH	Energy pulse indicator	Flashing frequency depends on the connected load.
ALM	Alarm indicator	Flashing when threshold is exceeded.

Switched PDU

Front Panel Ports

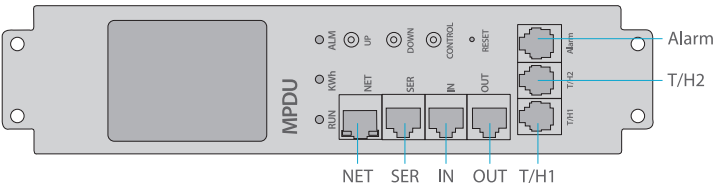

Ports	Description
NET	LAN/WAN communication port
SER	RS-485 serial communication port
IN	Connect to the OUT port of previous PDU
OUT	Connect to the IN port of next PDU
T/H1	Connect to temperature/humidity sensors 1
T/H2	Connect to temperature/humidity sensors 2
Alarm	Audible and visual alarm port

Front Panel Buttons

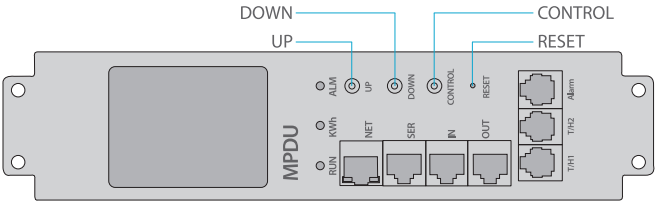

Buttons	Description
UP	Scroll up to the previous page.
DOWN	Scroll down to the next page.
CONTROL	Press to view the PDU status and configuration. Restore to factory settings: Press the CONTROL, then press the RESET.
RESET	Restart the device.

Front Panel LEDs

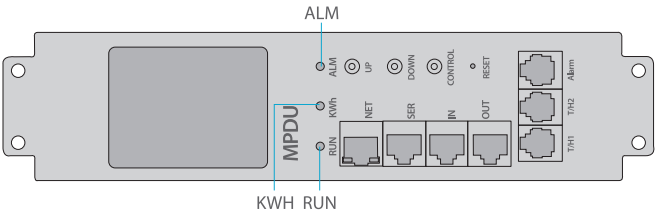

LEDs	Function	Description
RUN	Run indicator	Flashing every second.
KWH	Energy pulse indicator	Flashing frequency depends on the connected load.
ALM	Alarm indicator	Flashing when threshold is exceeded.

Site Environment

- The PDU is for indoor use only.
- Install the PDU in dry and ventilated place.
- Never install any electronic device or PDU during thunderstorms.
- Ensure the PDU voltage is consistent with the local one.
- Ensure the max. power of all devices is less than the PDU's.
- The PDU sockets are compatible with the matched plugs only.

PDU Installing

Rear Panel

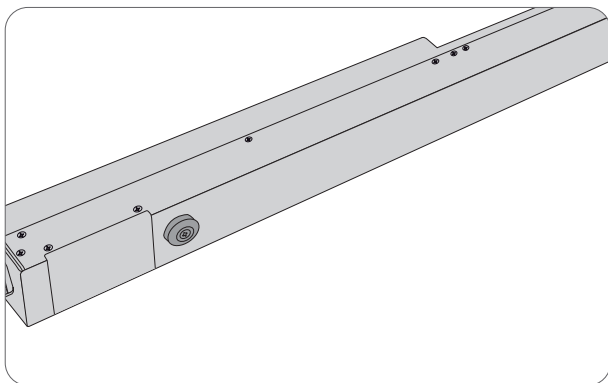

Mounting Pegs on the back of PDU are removable.

Method 1 Toolless Mounting

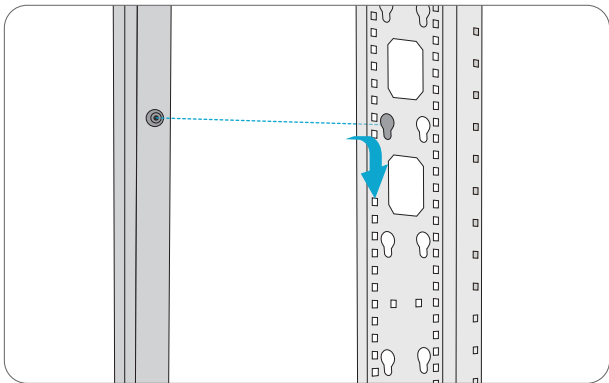

Align both Mounting Pegs to the slots of PDU bracket. Insert and slide down the PDU to lock firmly into place.

Method 2 Bracket Mounting

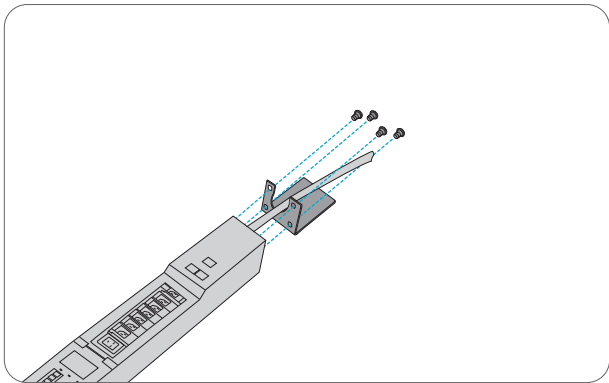

1. Installing the Brackets: Attach the vertical mounting brackets to two ends of PDU by pre-installed screws.

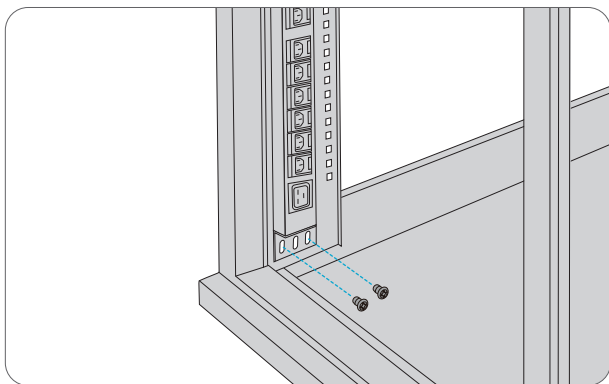

2. Rack-Mount Installation: Install the PDU to a vertical rail in your racks or cabinets using the supplied M6 screws.



NOTE: Only the bracket of the Switched PDU is removable. And you can dismantle the Mounting Pegs on the back of PDU according to your needs.

Electrical Installation

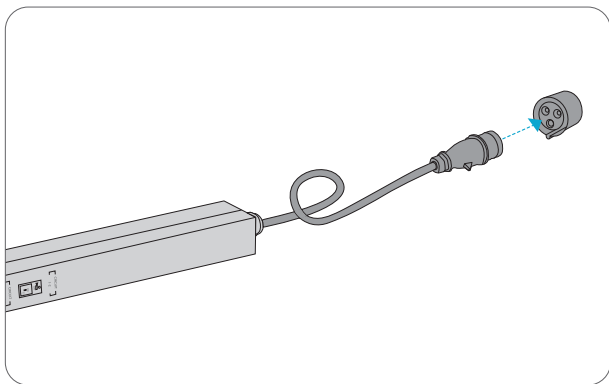

1. Plug the PDU into a compatible UPS system or wall receptacle.

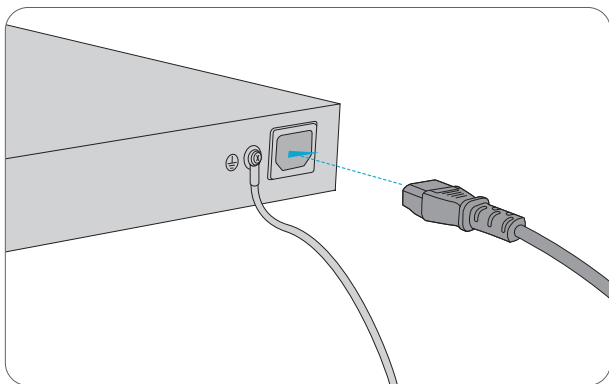

2. Plug the power cord into the power port of the switches, routers, servers or other device.



NOTE: It is extremely important not to exceed the PDU's maximum connected load.

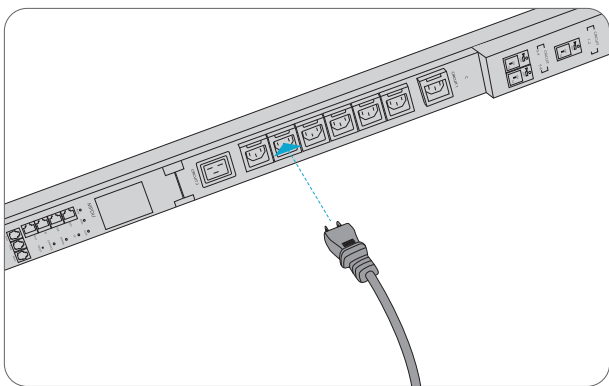

3. Connect the other end of the power cord to the outlet of PDU.



NOTE: The outlets of Metered and Switched PDU come with anti-fall buckle, which prevents the power cord from falling off.

Network Connection

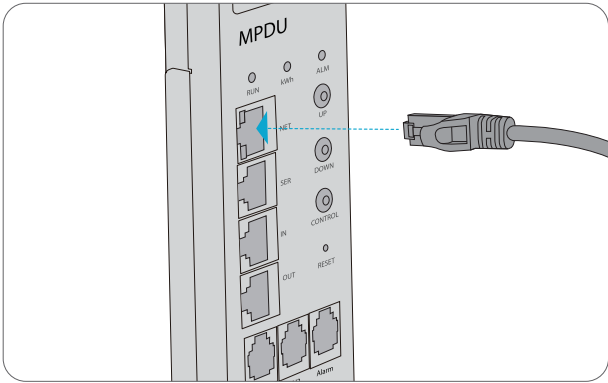

Attach one end of patch cable to the NET port on the front of the PDU, and the other end to a network port.

Environmental Monitoring (Optional)

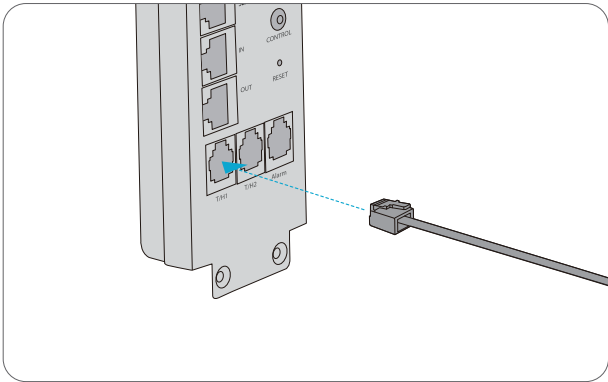

Plug one end into the T/H port on the PDU and the other end into the RJ45 port of Temperature/Humidity sensor. Then you can monitor the temperature and humidity data via the Web Interface.

Configuring the PDU

Step 1: Power on the computer and the PDU.

Step 2: Set the IP configuration on your computer. You must choose an IP address for the computer in the range of 192.168.1.1-192.168.1.162 or 192.168.1.164-192.168.1.254 for PDU that is not already in use.



NOTE: IP address of all PDUs is 192.168.1.163 by default.

Step 3: Open installed web browser on your PC, input the PDU's IP address `http://192.168.1.163`.

Step 4: When the login window appears, please enter the default username "admin" with the password "admin". Then click Login.

Welcome to IP-PDU.

User Name:

admin

Password:

.....

Login

Online Resources

- Download <https://www.fs.com/download.html>
- Help Center https://www.fs.com/service/help_center.html
- Contact Us https://www.fs.com/contact_us.html

Product Warranty

FS ensures our customers that any damage or faulty items due to our workmanship, we will offer exchange within 30 Days from the day you receive your goods. This excludes any custom made items or tailored solutions.



Warranty: FS Monitored and Switched PDUs enjoy 1 year limited warranty against defect in materials or workmanship. For more details about warranty, please check at <https://www.fs.com/policies/warranty.html>



Return: If you want to return item(s), information on how to return can be found at https://www.fs.com/policies/day_return_policy.html