

5 Entries Dome Fiber Optic PLC Splitter Splice Closure

Data Center & Cloud Computing Infrastructure Solutions



Overview

The fiber splice closure is used to house, organize, manage and protect fiber optic cables and splices, which is available in configurations that can accommodate from 24 to 96 single fiber splices.

It is suitable for protecting optical fiber splices in straight through and branching applications, and can be used in pole-mounted, wall-mounted and aerial fiber optic cable projects.

Features

- IP68 rating (Harsh environment & temperature)
- Very strong & robust shell
- No additional splice trays required
- Provides independent access to each cable port without disrupting surrounding cables

Applications

- Telecommunication Network
- CATV-Cable Television
- Wall-Mounted, Pole-Mounted, Aerial Application

Technical Specification

Parameters	FS-S018-5IO-24	FS-S018-5IO-48	FS-S018-5IO-96
Cable Ports	5 entries	5 entries	5 entries
Cable Diameter	Φ8~Φ25mm	Φ8~Φ25mm	Φ8~Φ25mm
Max Capacity of Fiber	24 fibers	48 fibers	96 fibers
24 Fibers Splice Tray	1pc	2pcs	4pcs
IP Rating	IP68	IP68	IP68
Installation Type	Pole-Mounted	Pole-Mounted	Pole-Mounted
Sealing Type	Mechanical seal type	Mechanical seal type	Mechanical seal type
Operating Temperature	-40°C~80°C	-40°C~80°C	-40°C~80°C
Lateral Pressure-Resistance	≥2000N/10cm	≥2000N/10cm	≥2000N/10cm
Shock-Resistance	≥20N.m	≥20N.m	≥20N.m
Dimensions (HxW)	16.54"x7.48"(420x190mm)	16.54"x7.48"(420x190mm)	16.54"x7.48"(420x190mm)
Net Weight	4.3kg	4.3kg	4.3kg

Notes: Installation of Pole-Mounted is default, the other can also be customized according to your requirements, please contact at sales@fs.com for details.

Main Accessories and Special Tools

Name of Accessories	Quantity
Heat Shrinkable Protective Sleeve	24~96pcs (Configuration as per capacity)
Port Plug (27 two layers)	4 sets
Port Plug (27 type 8 - 2*3)	4pcs
Port Plug (27 type 8 - 3)	4pcs
Port Plug (27 type 4 - 7)	4pcs
Port Plug (27 type 6 - 2*5)	4pcs
Port Plug (51 type 2 - 17)	1pc
Port Plug (51 type 16 - 7)	1pc
M8*60 Hexagon Screw	4pcs
M8*12 Hexagon Screw	4pcs
M8 Nut	8pcs
M8 Flat Washer	2pcs
M5*30 Screw and Nut	2 sets

Note: This splice closure comes with these accessories and tools.

Main Components

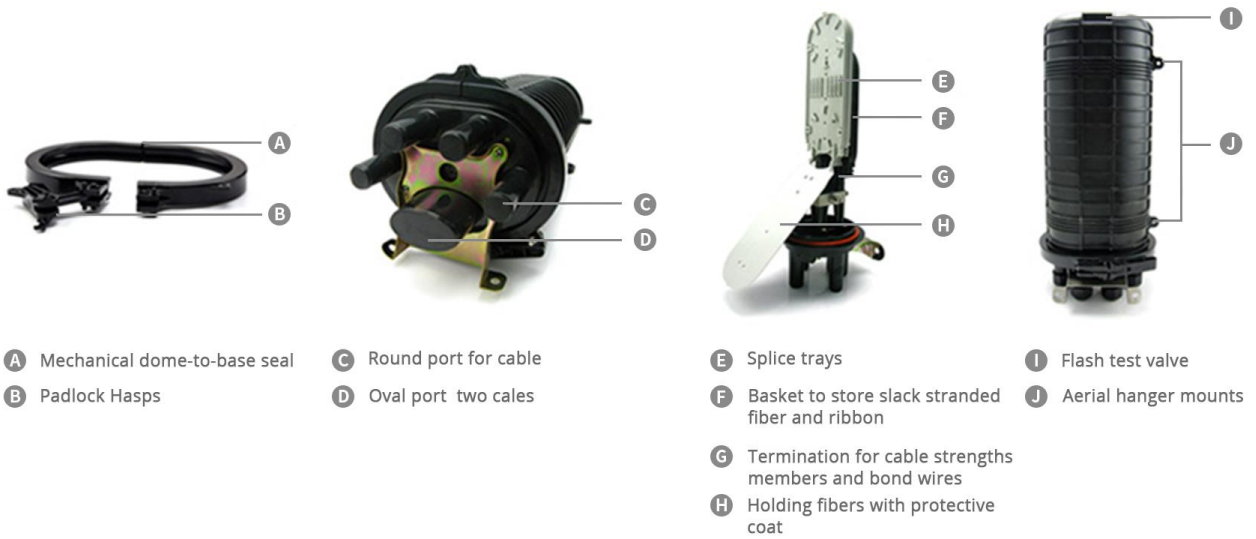

Ordering Information

ID	Description
#29073	5 Entries, 24 Single Fusion Splices Fiber PLC Splitter Splice Closure
#29074	5 Entries, 48 Single Fusion Splices Fiber PLC Splitter Splice Closure
#29076	5 Entries, 96 Single Fusion Splices Fiber PLC Splitter Splice Closure
#29062	2In-2Out, 16 Single Fusion Splices Fiber In Line Splice Closure
#34111	6 Entries, 12 Single Fusion Splices Fiber Dome Splice Closure
#73712	Customized 2In-2Out Single Fusion Splices Fiber In Line Splice Closure
#73713	Customized 4In-4Out Single Fusion Splices Fiber In Line Splice Closure
#73714	Customized 3In-3Out Single Fusion Splices Fiber In Line Splice Closure
#73715	Customized 6 Entries Single Fusion Splices Fiber Dome Splice Closure



 <https://www.fs.com>



The information in this document is subject to change without notice. FS has made all efforts to ensure the accuracy of the information, but all information in this document does not constitute any kind of warranty.